



Industrial Conveyor Specialists

**Installation, Maintenance & Parts Manual
For**

Pallet Pro

Heavy Duty Plastic Belt Conveyor

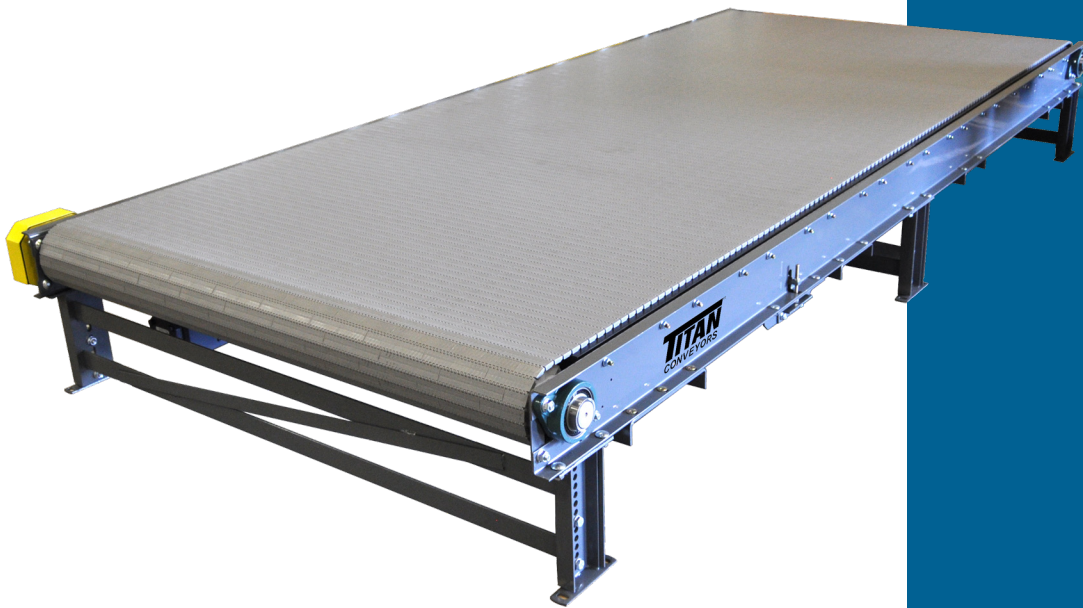

**Titan Conveyors
735 Industrial Loop Road
New London, WI 54961
920-982-6600
800-558-3616
FAX 920-982-7750
E-mail: sales@titanconveyors.com
Website: www.titanconveyors.com**

Serial No.



Table of Contents

Page 2	Table of Contents
	Warranty
Page 3	Safety/Safety Decals
	Belt Safety Warnings
Page 4	Introduction
	I. Receiving
	II. Installation
	Support Assembly
Page 5	Component Checklist
	Belt Installation
Page 6	Placement of Sprockets
	Sprocket Installation
	Belt Threading Chart
Page 7	III. Maintenance
	Motors
	Reducers
Page 9	Bearings
Page 10	Chain & Sprockets
Page 11	Plastic Chain Conveyor Blow Apart Drawing

Warranty

(A) Seller warrants that the material in and the workmanship on the equipment manufactured by TITAN will be free from defects at time of shipment. If during the first year from the date of shipment, the Buyer establishes to the seller's satisfaction that any part or parts manufactured by TITAN were defective at the time of shipment, TITAN will, at its own expense, repair or replace (but not install) replacement parts. For a time purpose of this warranty, one year will constitute 2080 hours of operation based on an 8 hour day. Sellers liability under this warranty is limited to replacement parts only and the seller will make no allowance for corrective work done unless agreed to by the seller in writing. Charges for correction of defects by others will not be acceptable, unless so authorized in writing, prior to the work being performed, by an officer of the company. Damage caused by deterioration due to extraordinary wear and tear (including, but not in limitation, use said equipment to handle products of a size, weight and shape or at speeds or methods which differ from information originally provided), chemical action, wear caused by the presence of abrasive materials or by improper maintenance or lubrication or improper storage prior to installation, shall not constitute defects. Failure to install equipment properly shall not constitute defects. Warranty does not cover consumable items. Warranty does not cover belt tracking or adjustment at installation or periodic adjustment that may be required during normal operation. Refer to the maintenance manual for belt tracking instructions.

(B) Seller has made no representation, warranties, or guarantees, expressed or implied, not expressly set forth on above paragraph. Seller shall not be liable hereunder for any consequential damages included but not in limitation, damages which may arise from loss of anticipated profits or production or from increased cost of operation or spoilage of material.

(C) The components used in manufacture of said equipment which were manufactured by others will carry such manufacturers' customary warranty, which seller will obtain for buyer upon request.

(D) No representative of TITAN has been conferred with any authority to waive, alter, vary or add to the terms of warranty state herein, without prior authorization in writing executed by an officer of the company.

(E) The foregoing is in lieu of any and all other warranties, expressed or implied, or those extending beyond the description of the product.

PALLET PRO HEAVY DUTY PLASTIC BELT CONVEYOR

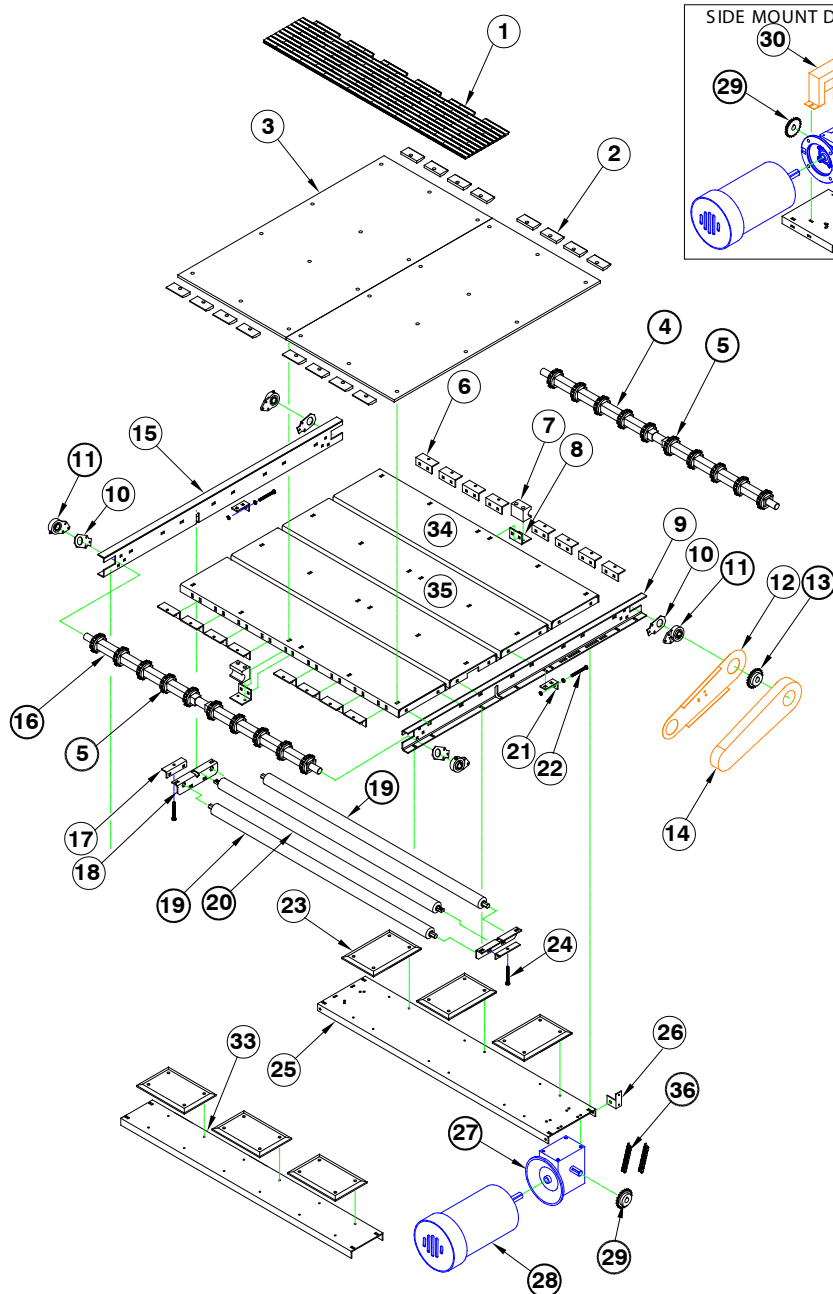

1. UNI-BELT PLASTIC BELT
2. DECK EXTENSION
3. DECK
4. • **DRIVE SHAFT**
5. • **BELT SPROCKET**
6. DECK EXTENSION SUPPORT ANGLE
7. CENTER SHAFT PLASTIC SUPPORT
8. CENTER SHAFT PLASTIC SUPPORT ANGLE
9. FRAME RIGHT SIDE
10. INFEED & DISCHARGE BEARING SPACER
11. • **INFEED & DISCHARGE BEARING**
12. BOTTOM MT. DRIVE GUARD BACK
13. • **DRIVE SPROCKET**
14. BOTTOM MT. DRIVE GUARD FRONT
15. FRAME LEFT HAND
16. • **INFEED SHAFT**
17. TAKE-UP BRACKET ANGLE
18. TAKE-UP BRACKET
19. • **SNUB ROLLER ASSEMBLY**
20. • **TAKE-UP ROLLER ASSEMBLY**
21. MOTOR BASE ADJUSTMENT ANGLE
22. TAKE-UP BOLT MOTORBASE
23. BELT RETURN PLASTIC
24. TAKE-UP BOLT
25. MOTOR BASE BOTTOM MOUNT DRIVE
26. DRIVE GUARD BACK BRACKET BTM. MT. DR.
27. • **REDUCER**
28. • **MOTOR**
29. • **DRIVE SPROCKET**
30. SIDEMOUNT GUARD
31. SIDEMOUNT GUARD BOTTOM
32. MOTOR BASE SIDEMOUNT DRIVE
33. OPTIONAL BOTTOM SPREADER
34. END TOP SPREADER
35. MIDDLE TOP SPREADER
36. • **ROLLER CHAIN**

• **RECOMMENDED SPARE PARTS TO BE STOCKED AT YOUR LOCATION**